

Do you have a deer problem?

- Do you frequently see deer on your property and/or in your neighborhood?
- Have you had plants and shrubs damaged by deer?
- Are deer using your property to feed, rest or travel through?
- Have deer cost you money by damaging your plants and landscaping?
- Is your landscaping less than you'd hoped for because you can only use deer-resistance plants?
- Are you considering costly fencing simply to keep out deer?
- Is the deer population a hot topic in your area?

If you checked off 3 or more of these questions...

YOU HAVE A DEER PROBLEM!



Corporate Office:

45 Cross Avenue
Midland Park, NJ 07432

Branch Office:

922 South Avenue West
Westfield, NJ 07090

Call 888-612-2847 Today for Your FREE Analysis!

Or Visit www.horizonpestcontrol.com

Horizon Deer Guard



Reclaim Your Yard!

Deer populations have skyrocketed, and the problem is only getting worse.

We can reduce the damage caused by deer in your yard **ALL YEAR ROUND!**



Horizon & You: Together, we can reduce deer damage on your property!

Horizon Deer Guard

Chances are, if you're reading this brochure, you are part of a large number of people fighting a losing battle against growing deer populations. The Wall Street Journal reports that deer cause severe environmental damage when population densities are greater than 15 deer per square mile and in our area, densities meet or exceed that range.

A Custom Approach that Sets Us Apart

Horizon provides a custom approach to protect your property, utilizing multi-zone and multi-product technologies. We rotate scent-based natural deterrents with taste deterrents so deer become frustrated and disinterested in your property as a feeding area.

- **Zone 1**—The first line of defense is your property's perimeter. If deer are in the area, but have yet to enter your yard, a predator repellent can be very effective because it creates anxiety toward entering your yard. Over time, deer may become used to one repellent, which is why we take the extra step to rotate repellents.
- **Zone 2**—If deer are already travelling through your yard or feeding in your yard, a scent deterrent may not be enough. Taste deterrents stop deer from eating existing plantings because they have an aversive flavor. Deer repellent plants naturally contain these aversive flavors, but let's face it, sometimes you want more unique and diverse planting to set your landscaping apart.
- **Zone 3**—Closer to your home, it's critical to prevent deer from feeding on your most precious plantings. To reduce the likelihood of deer developing a taste preference, we rotate our taste deterrents, so there is no chance the deer could get used to the flavor.

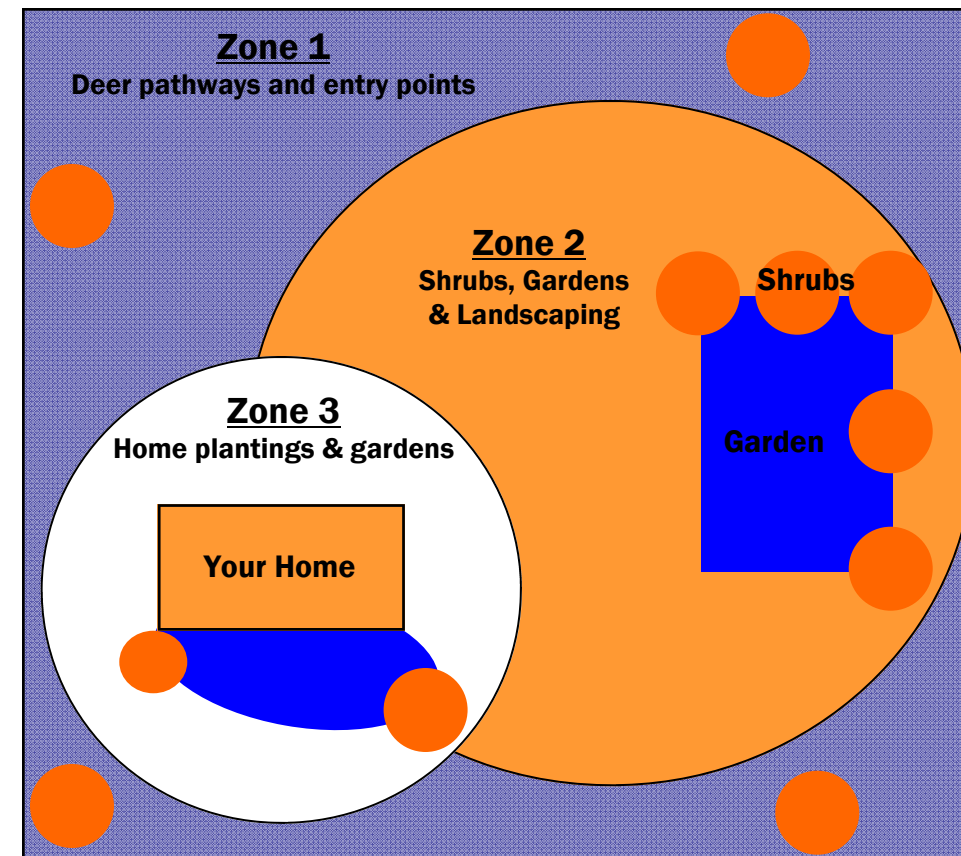

Call 888-612-2847
for Your FREE Property Analysis!